

1 2 3 4 5 6 7 8

REVISIONS		
ISS	ZONE	DESCRIPTION\PER REQUEST\DATE

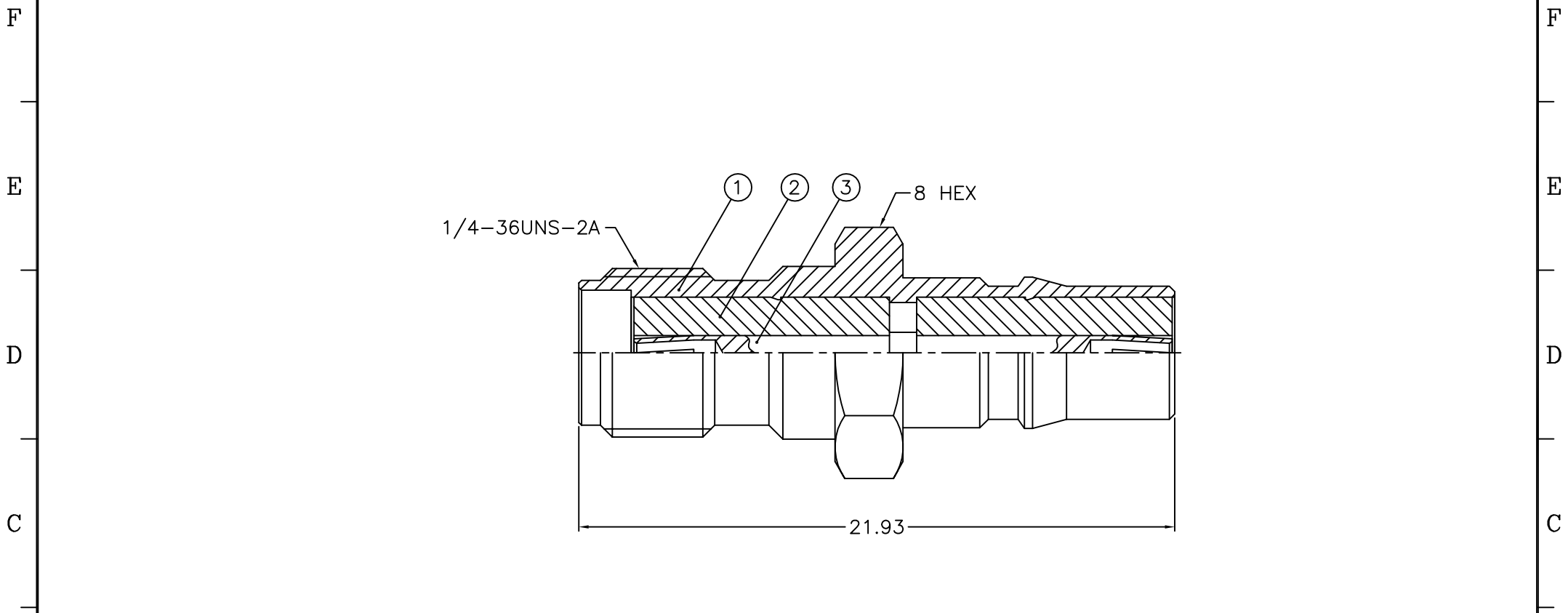

NOTES: FINISH (PLATING THICKNESS IN MICRO-INCHES)
 1. BRASS
 2. NICKEL PL. 100 MIN. THICK OVER COPPER PL. 50 MIN. THICK
 3. BERYLLIUM COPPER
 4. GOLD PL. 3 MIN. THICK OVER NICKEL PL. 50 MIN. THICK
 OVER COPPER PL. 50 MIN. THICK
 5. TEFLON

DIMENSIONS ARE IN MILLIMETERS				PART NO.		TITLE SMA FEMALE TO QMA FEMALE ADAPTOR
UNLESS OTHERWISE SPECIFIED TOLERANCES				APPROVED	DATE 07-06-'11	
0.5-6 = ±0.2 6-30 = ±0.4 30-120 = ±0.6 120-315 = ±1 315-1000 = ±1.6 1000-2000 = ±2.4				CHECKED	DATE 07-06-'11	
				DRAWN GOLDEN	DATE 07-06-'11	
3	CONTACT PIN	NOTE 3	NOTE 4	1	100-SMAF-QMAF-3	DRAWING NO. 100-SMAF-QMAF-50
2	INSULATOR	NOTE 5	NATURAL	2	100-QMAF-3-50T	FILE NO. R:\D\G\DWG\100\SMAF-QMAF\50-1
1	BODY	NOTE 1	NOTE 2	1	100-SMAF-QMAF-1	
NO.	DESCRIPTION	MATERIAL	FINISH	Q'TY	DRAWING NO.	

A 1 2 3 4 5 6 7 8